

429 END OUTLINE MARKER BULB LAMP

Front + rear. Lens uncoloured + red.

429.00
12V OR 24V

Approved to TUV (Germany) standards "Carriage of dangerous goods".

Spare Parts

- 10251.03 Lens Uncoloured.
- 10251.04 Lens Red.
- 12V Bulb L207
- 24V Bulb L149

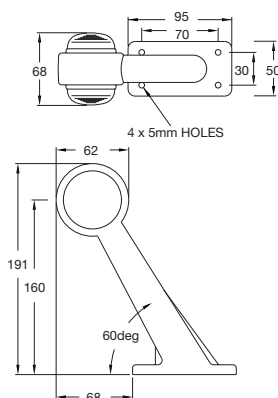

427 END OUTLINE MARKER BULB LAMP

Front + rear. Lens uncoloured + red.

427.300
12V OR 24V

Approved to TUV(Germany) standards "Carriage of dangerous goods"

Spare Parts

- For LED versions see page 73.
- 10051.01233 Lens Uncoloured.
- 10044.01233 Lens Red.
- 12V Bulb L207.
- 24V Bulb L149.

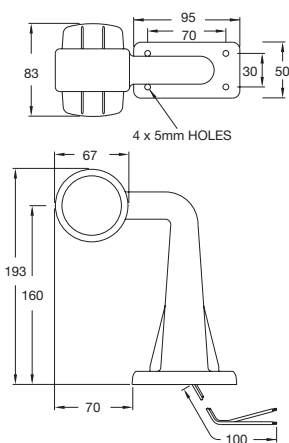

430/431 END OUTLINE MARKER BULB LAMP

Front or Rear. Lens uncoloured or red.
Front - uncoloured. Rear - red.

430.00
431.00
12V OR 24V

Spare Parts

- 10047.7262 Lens Uncoloured.
- 10046.01262 Lens Red.
- 12V Bulb L209 (Double Contact).
- 24V Bulb L150 (Double Contact).



FRONT REAR

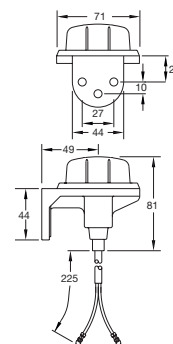

Britax PMG have been supplying lamps to the automotive industry for **over 60 years**. Originally founded as **PMG Thorpe Limited**