

### 14201 SINGLE POLE SOCKET

2 screw terminals. Fitted with thermoplastic lid. Max 240w@24V DC

**14201.00**

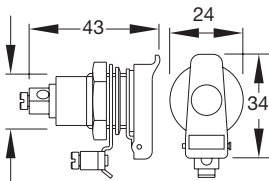

M18x1  
MAX PANEL THICKNESS 6mm

### 3540 JUNCTION BOX

Rubber body. 8way screw connection. 15amp rating.

**3540.00**

#### Spare Parts

12044 Clear Cover. 14123 8 Way Connector Strip.

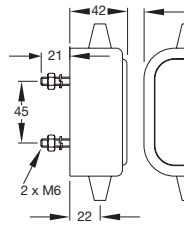

### 13340100 SWITCH, PRESS BUTTON

Rubber cap. Spring loaded momentary contact - normally open. Single pole. Screw connections. Current rating resistive load 20A@12V. 10A@24V.

**13340100 12V OR 24V**

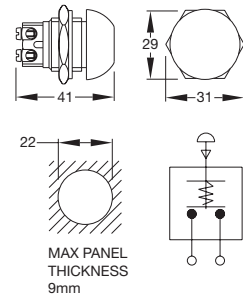

MAX PANEL THICKNESS 9mm

### 14094 SINGLE POLE SOCKET

2. 6.3mm male blade terminals. Fitted with thermoplastic lid. Max 240w@24V DC

**14094.00**

Max panel thickness 6mm

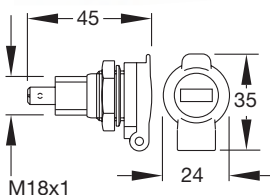

M18x1

### E05 JUNCTION BOX

10way junction box for 12V and 24V applications supplied with fixing bolts and rubber grommets for:- 3 x 7 core round cable. 4 x 4/5 core round cable. 7 x 2 core flat or 6.2mm round cable\*/supplied not pierced, as blanks.

**E05.00 12v or 24v**

As fitted to lfor Williams Trailers.

#### Spare Parts

K02.00 Grommet Kit 7 Core Round. K02.01 Grommet Kit 4 & 5 Core Round. K02.02 Grommet Kit 2 Core Round + 2 Core Flat.

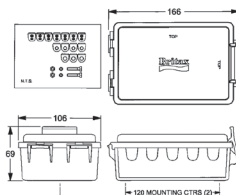

126 MOUNTING CTRES (2)

### 29102 AUDIBLE WARNING DEVICE

Grey. Reverse warning. Sounds available: Buzz - very fast sweep at approx 120Hz. Fast sweep 2.5kHz - 3kHz sweeping 9 times/sec. Slow sweep 2.5 kHz - 3kHz sweeping 3 times/sec. Continuous 2.7kHz.

**29102.00 12V OR 24V**

